

# BRUCE MATHER

INDEPENDENT ESTATE AGENT



**42 Charter Close, Boston, PE21 9PD**

**Asking Price £145,000**

A semi-detached two bedroom home in a desirable quiet cul-de-sac on the edge of Boston, close to Pilgrim Hospital sold with NO ONWARD CHAIN. This house ticks a lot of boxes with off street parking and a contained mainly grassed garden to the rear.

Upstairs are 2 bedrooms and a bathroom, downstairs off the entrance porch there is a reception room and kitchen/dining room.

The property is located on the outskirts of Boston where you can find, schools, shops, restaurants and all the usual amenities., in the popular residential end.

To arrange a viewing please call Bruce Mather Estate Agents on 01205365032 to arrange a viewing.

# Floor Plan

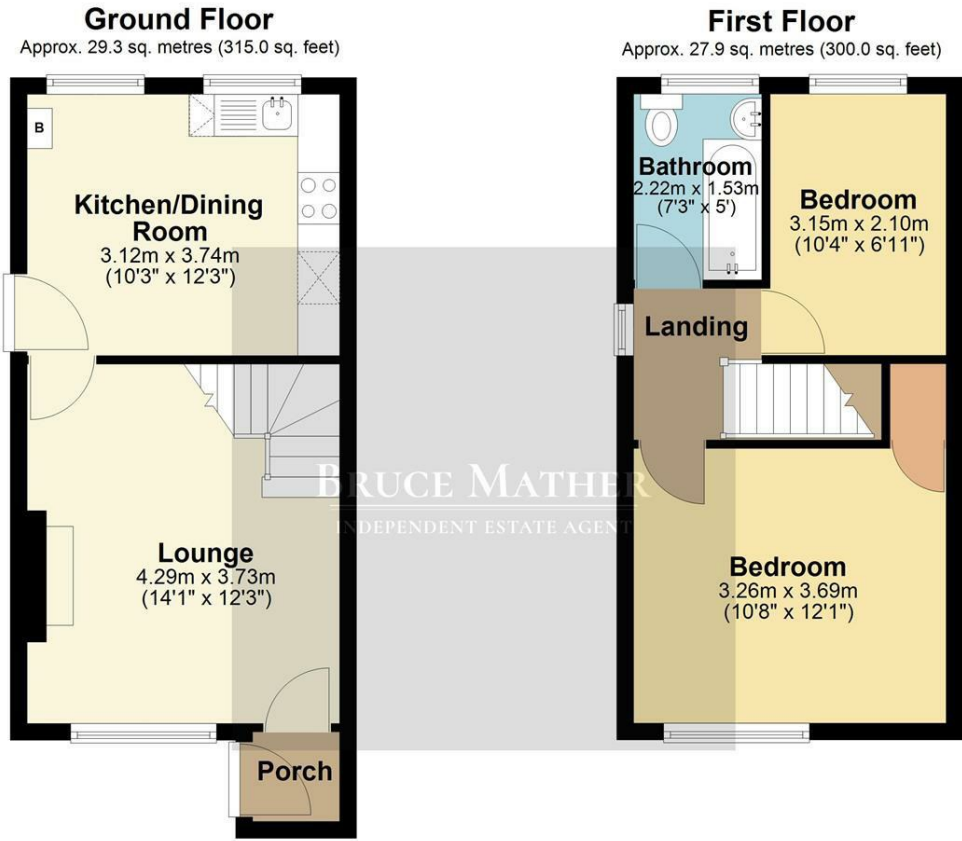

All images used are for illustrative purposes. Images are for guidance only and may not necessarily represent a true and accurate depiction of the condition of property. Floor plans are intended to give an indication of the layout only. All images, floor plans and dimensions are not intended to form part any contract.  
Plan produced using PlanUp.



# Area Map

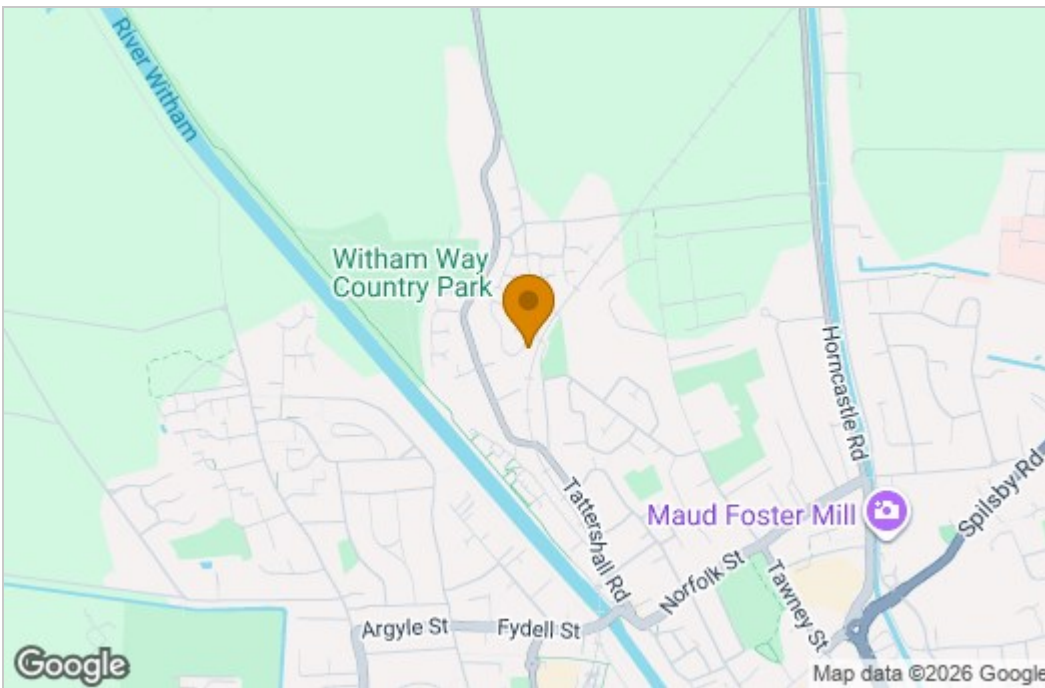

# Energy Efficiency Graph

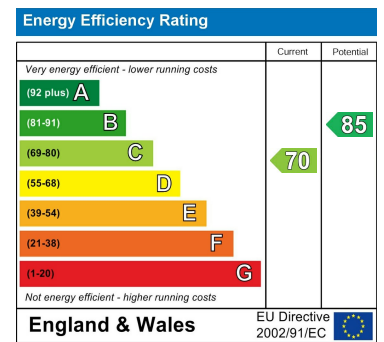

These particulars, whilst believed to be accurate are set out as a general outline only for guidance and do not constitute any part of an offer or contract. Intending purchasers should not rely on them as statements of representation of fact, but must satisfy themselves by inspection or otherwise as to their accuracy. No person in this firm's employment has the authority to make or give any representation or warranty in respect of the property.